

# ProVolver Setup EN test

You got your hand on a ProVolver. With this, you will increase your immersion while playing. The ProVolver allows you to feel the handguns in your games. You can use it with one hand or with two hands with the front extension.

⌚ Setting up your ProVolver should take 10 to 20 minutes.

First, make sure you work in a clear area and be very careful. Some parts can get lost easily.

## Parts list



### Content of the box



x1

ProVolver haptic  
Module



x1

ProVolver rear  
controller mount  
(cup)



x1

ProStrap



x1

Charging cable USB  
to USB-C



x1

USB Bluetooth dongle



### If you took the front extension



x1

Front magnetic bracket



x2

M4x12 screw



x1

Controller mount (cup)



x1

ProStrap

---

---

### Tool bag



x1

Hex Key 0,4cm



x1

Hex Key 0,25cm

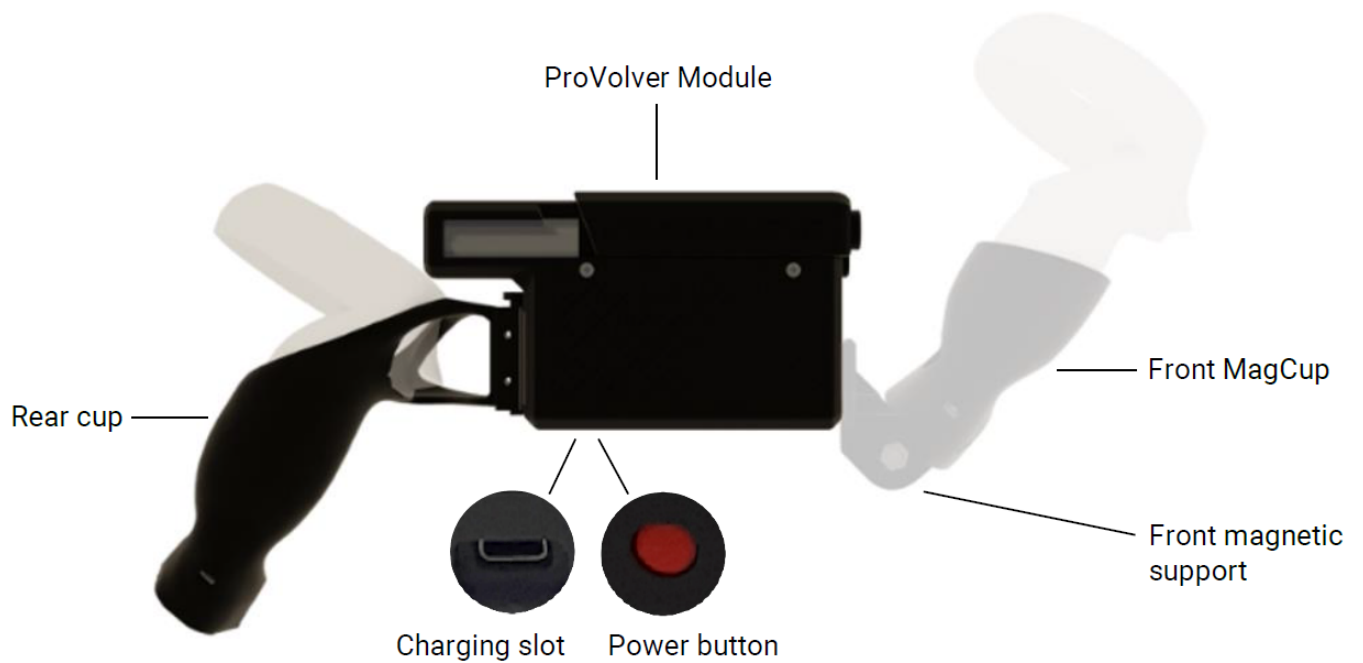

## Step 1: Slot the controller into the rear cup

---

---

For Quest



Slide the controller into the Cup. If you chose the right-handed version, put the right controller in and vice versa.



For Rift S, Quest 1, 2, 3, 3S & Pro, you need to press the trigger to introduce and remove the controller from the cup.

#### For Valve Index



Detach the strap's string from the controller and put the cup into the controller's handle, like shown in the picture above.



Just clip the controller in the cup and put back the strap's string through the cup and controller.

## Step 2: Attach the Main cup to the ProVolver

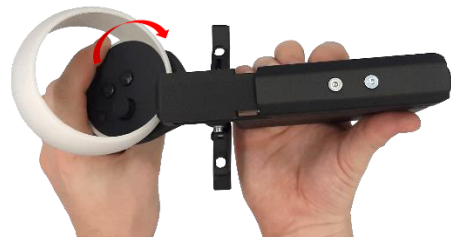

Make sure the clamps are loosened (see picture above).  
Place one side of the female rail on the male rail.

Then clip the other side of the female rail (it can be a little tricky at first since the piece is not shaped yet).

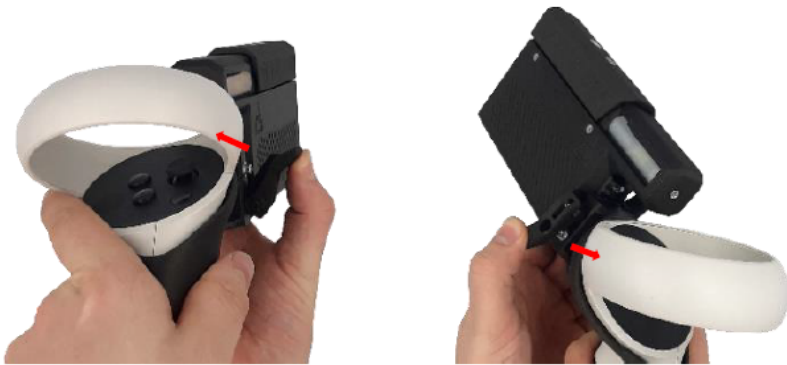

Clip the first clamp. Use the provided Allen key to loosen the screw and adjust the tightness.  
Do the same on the other side to lock the module.



● Screw whole

If you got the ProVolver for Valve Index, there will be a magnetic add-on provided. You will need it only if you choose to use it with a gunstock or with a stock extension. You can fix it forward or backward or in the middle, as you prefer.

*Note: if you install it before trying to fit the controller in, you will not be able to. Neither will you be able to remove it.*

*You will need to remove the magnetic part beforehand.*



If you use your ProVolver single-handedly, you can refer to the [Haptic documentation](#) to connect it to your wireless Headset or PC.

If you took the front magnetic bracket in option to use the ProVolver as a two-handed weapon, keep following this tutorial.

(note to Tao: pay attention to each image in this section, none of the red indicators are present)

## Step 3: Attach the front extension

---

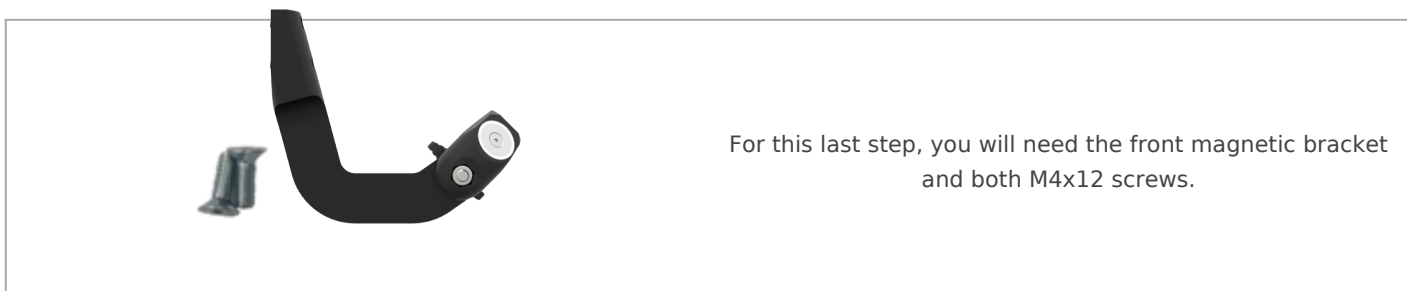



You can place the bracket on either position 1 (higher) or position 2 (lower) as shown above depending on your appreciation.



Screw it in place using the smaller Allen key and both screws.



Put the front cup on the Magnetic support.



Loosen the thumbscrew to adjust it.  
Slot the controller in the cup.  
Adjust your front hand in game and tighten the screw back.

**Congratulations!** Your ProVolver is now ready to be paired.

You can now follow the [Haptic documentation](#) to connect it to your gear and enjoy the recoil in your favorite shooters!

Revision #16

Created 24 April 2025 10:34:48 by jon

Updated 16 May 2025 14:07:10 by Sephooth