

MagTube Gunstock

All documentation pertaining to our MagTube Gunstock including FAQ, Quick Start Guide, and Tutorials.

- [Frequently Asked Questions](#)
 - [MagTube Gunstock FAQ](#)
- [Quick Start Guide](#)
 - [Getting Started](#)
 - [Setting up the MagTube](#)
 - [Using your MagTube for the First Time](#)
 - [Important information for Meta Quest \(any model\) users](#)
 - [Basic troubleshooting & tips](#)
- [Tutorials](#)
 - [YouTube Videos](#)
 - [Bipod Setup EN](#)
 - [MagTube Upgrade EN](#)
 - [Gunstock MagTube ForceTube Switch Side EN](#)
 - [Gunstock MagTube ForceTube Setup EN](#)

Frequently Asked Questions

Get to know the MagTube Gunstock better through these frequently asked questions.

MagTube Gunstock FAQ

- **Are the mounts magnetic?** Yes. We haven't sold fasteners in many years. We only sell magnetic gunstocks.
Can I switch primary hands? Yes, instructions [here](#) (prompts pdf download).
- **Carbon vs Chrome tubes which is better?** Carbon tubes are lighter, more durable, and non-reflective. Chrome tubes are heavier, sturdy, and reflective. If you have an HMD that has poor tracking with reflective surfaces (such as Valve Index), consider Carbon or cover your Chrome tubes. **Carbon is ~112g lighter**
- **Carbon vs other controller mounts which is better?** The carbon cups use a carbon filament and the other cups use PLA filament. The carbon cups are lighter and more durable. Additionally they have a slightly more 'grippy' feel to them compared to PLA which feel 'smoother'.
- **Should I get the bipod?** You have to consider how you will use it. Does your play space allow for use while standing or crouching by letting you sit it on something for stability? Can you comfortably accommodate its usage? The bipod is a very powerful tool when used properly.
- **Should I get the controller mount bracket?** This is for if you want to quickly change position of your controller on the gunstock without having to manually adjust one of them. For example, when changing from a rifle to an SMG. It is down to preference, and you can always buy one separately later on. **This is an optional add on. You don't need it to use the stock.**
- **Should I get the ProStraps?** While only available for certain HMDs, they are highly recommended for the added comfort they offer. Ordering them this way also likely means **they will come pre-installed**.
- **What are the differences between MK1 and MK2 static stock?** The MK1 is the original stock design we have used and refined since the beginning. The Mk2 is a new design that allows for height adjustment, and additional cheek weld comfort. With the new design, users have even more adjustability for the perfect alignment. Especially useful for inside out tracking HMDs such as Quest 3 where it is important for the HMD to see the controllers at all times.
- **I just got MagTube for Ghosts of Tabor how do I set it up?** Here is the [MagTube Quick Start Guide](#). Here is a [twitch clip](#) for ragesaq's setup which serves as a great baseline to personalize, as well as a [YT video](#) by ScopeOG to follow.
- **I just got MagTube for Contractors Showdown how do I calibrate in game?** For both Battle Royale and the new Exfil mode, you calibrate in Battle Royale. Your calibration will carry over to Exfil. If you cannot adjust enough in the calibration, you will need to physically adjust your stock to compensate. Best practice is to learn how to adjust your stock to align to any gun in any game, and then use the in game calibration for additional ease/comfort. Don't rely entirely on the in game calibration. Not every game has an in game calibration.
- **I think my cups aren't magnetic?** Your MagTube may have arrived with the cups attached. The magnets are strong unless the cup is moved at a certain angle (rotate inward depending on which hand i.e. right hand cup rotate counter clockwise, left hand clockwise) and they will easily detach.
- **One of the magnetic mounts on the MagTube is smooth, is this on purpose?** Yes. The trigger hand supports most of the gunstock's weight. A notched magnet retainer keeps it locked in place when tightened to avoid involuntary changes of angle. The spacing of the notches still allows for a good amount of adjustment. The supporting hand magnet retainer is smooth to allow finer adjustment on the fly. Think of a clock. If the notched magnet retainer can adjust in hours, the smooth one can adjust in seconds. If you want both controllers on notched magnet retainers, you can buy a second one [here](#) (select notched).
- **How do I use the sling?** The slings, both 1 point and 2 point, are like the ones used on actual rifles and pre-existing guides for how to use those all apply. Such as [this one](#).
- **1 point or 2 point which sling is better?** That is down to preference. 1 point attaches to the stock at 1 point, and 2 point attaches to both mounting points on the stock. You can use the 2 point as 1 point by attaching both sides to the same point on the stock.

Quick Start Guide

Just got your MagTube Gunstock? Read this to learn how to use it like a pro in no time. This basic guide is intended to provide first time owners with the immediate necessary information to go from unboxing to using in game.

Getting Started

Getting Started (no ProStraps):

1. After unboxing, the first thing you need to do is get the mag cups. They will be in their own bubble wrap bag, or already on the MagTube. If they are already on the MagTube, you can grab a cup firmly, and remove by using a doorknob twist motion.
2. On each cup will be writing to indicate if it is for the left or right controller. Underneath, where you see the magnet, you might also see some more writing indicating which brand the cups are for (i.e. Quest 2). **Please note: if you ordered ProStraps, they might already be pre-installed on the cups. I will cover those separately below.**
3. Before putting your controllers into the cups, it is suggested to wipe down the part of the controllers that will go inside. This is to ensure optimal friction so they do not slide out easily. Next, observe the small hole in the cup. This is intended for feeding the wrist strap through, and should be facing you, or away from the trigger button on the controller. The magnet on the bottom of the left cup should be angled towards the right, and the magnet on the bottom of the right cup angled towards the left.
4. To install, simply start with the wrist strap and feed it through the small hole. Then push the controller into the cup until it cannot go any further. Use of excessive force is not required as it should easily go in until it hits friction, and then with a little bit of force you should be able to continue pushing in until it won't go any further. That is the point at which you should stop and it is considered installed in the cup. **Please note: if you are using Index or PSVR 2, we have videos in Website tutorials under Cup.**

Getting Started (with ProStraps):

1. All steps above apply. **Before** putting controllers into the cups you will need to install the ProStraps as shown in our [tutorials](#). Depending on your controller brand, and the state in which they were received (pre-installed vs separately) what you do may vary. But essentially, you need the bottom to be on the cup, and the top to either be connected to an insert you put inside your controller's battery cover (ProStraps Grips), or inside the cup itself (ProStraps GRips MK2 Flex for controller holder).
2. Once the ProStraps are correctly installed, you follow step 4 above.

Setting up the MagTube

Setting up the MagTube:

1. Once out of the bubble wrap bag, unfold the MagTube. If the tubes are not freely moving at the joints, you can use the larger of the 2 allen keys provided in a separate bag to loosen them.
2. Observe your MagTube. There will be 2 brackets with magnets in the same shape as the ones in the cups on two separate tubes. By default, your Magtube is set up for dominant right hand use. To switch hands follow the tutorial on our website. You will also see two open ring parts, one at the very back, and another on the connector to the longest tube. These are mounting points for the sling.
3. Install the sling on these mounting points. If you chose a 1 point sling, mount it near the back.
4. You may put the controllers with the mag cups on the MagTube.
5. Now take a moment to inspect your MagTube. Pay attention to where you see bolts, and black butterfly knobs. The bolts will be adjusted with the larger allen key. Loosen and tighten different things later on to adjust position and articulation to your liking. It is now ready for use!

Setting up the MagTube (Bipod):

1. If you ordered a bipod, this is a good time to install it following our [tutorial](#). For ease of installation, it is recommended to have both controllers off the MagTube.

Using your MagTube for the First Time

Using your MagTube for the first time:

1. The first thing you will need to do is adjust/align your MagTube so that you can see through the sights on firearms. This [video](#) by community member ragesaq is perfect to follow along. You loosen and tighten the aforementioned things to adjust everything shown in the video.
2. Once you follow the video practice makes perfect! It may take some time to get the adjustments and alignment dialed in to suit your preferences. It will also take some time to get used to detaching and reattaching the controllers to the MagTube, and to reload firearms, etc. For additional tips, and community shared MagTube setups, head over to our [Discord](#).
3. For pump action shotguns there are multiple ways to pump rounds. One popular method is to loosen the supporting hand controller mount enough so it can freely move forward and backward along its axis (not to be confused with loosening the entire bracket on the tube) but tight enough as desired by preference. Then simply rock the controller back and forth to pump.

Important information for Meta Quest (any model) users

1. Being inside out tracking, the sensors on both controllers need to be visible by the headset to maintain optimal tracking. You will want to keep this in mind when setting up your gunstock to align to guns in games.
2. On newer models that have hand tracking, you will want to make sure hand tracking is disabled when gunstock is in use. The hand tracking gets confused, and tries to engage, causing tracking issues. This also applies when using a Meta Quest on PC.

Basic troubleshooting & tips

1. If the MagTube feels wobbly or 'loose', tighten the various joints using the larger of the 2 allen keys provided. If the cups feel wobbly or 'loose, tighten the magnets on the cup and the stock using the smaller of the 2 allen keys provided.
2. You can save yourself some effort when changing setup for different games by taking pictures of what works in a particular game before changing it, to make it easier to go back to later on.
3. If you are trying to figure out how to use your 1 point or 2 point sling, there are countless video guides on YouTube for airsoft, and actual firearms that translate perfectly to MagTube use.
4. Much more information is provided in the links shared at the very start of this guide. I did not cover any of that information here.

Tutorials

All the tutorials traditionally found on our website, pertaining to the MagTube gunstock in alphabetical order

Tutorials

YouTube Videos

<https://www.youtube.com/embed/R7SYyDTQNfs?si=5oMRc6zgSWPVobbC>

https://www.youtube.com/embed/yX5ITCMh_3Y?si=DB4Xc4cegNq47uCY

Bipod Setup EN

The Bipod allows you to play VR Shooter games with the stability of a real sniper rifle.

🕒 Upgrading your Gun Stock with the Bipod should take about 1 minute.



Pull down the screw and unfold the legs.



Spin the bipod extremities to extend them. (note to Tao: some people get confused on which way to turn it to tighten or loosen)



Loosen the scroll wheel down to max.



Push the little lever on the right to open the bipod top. Put the Gun Stock tube inside the bipod.



The ProTubeVR logo needs to be in front of you when you hold the Gun Stock.
Tighten the scroll wheel to adjust and tie the bipod.

MagTube Upgrade EN

The MagTube allows you to detach the controllers (and its magnetic cups) from the frame without having to take the controllers off the cups, therefore increasing your comfort while playing.

🕒 Upgrading your ProTube to a MagTube should take 10 minutes.

Make sure you work in a clear area and be very careful. Some parts can easily be lost.

PARTS LIST

Upgrade Parts			Tools bag	
				
x2	x1	x1	x1	x1
Pair of controller holders (cups)	Notched retainer	Smooth Bracket	Hex Key 4mm	Hex Key 2,5mm

Step 1: Dismantle the fixed cups

You need to remove the fix cups on your ProTube using the provided larger Allen key. Make sure to keep all screws and bolts.

STEP 2: The rear magnetic cup



What you need for the rear MagCup
(medium tube):

- 20 mm screw
- 1 nut
- 2 O-rings
- Notched magnetic support
- Magnetic cup



Put the O-ring on the 20mm screw.



Pass the screw and O-ring through the notched magnetic support.



Join the notched magnetic support and the T-notched connection and add the second O-ring.



Add the nut and tighten, the magnetic support must be able to move though.

STEP 3: The front magnetic cup



What you need for the front MagCup
(longer tube):

- Smooth magnetic bracket
- Magnetic cup



Remove the old smooth 3D printed T-connection from the front longer tube. Replace it with the new magnetic bracket.
The magnet must face the other way to the rear magnetic bracket
(ex: to the left if you are right-handed).



You can now install your new magnetic controller holders (cups).
Congrats! You now have a complete MagTube.

Gunstock MagTube

ForceTube Switch Side EN

MagTube Rifle, with static stock.

Or

ForceTube Rifle, with haptic recoil stock.

For either of them, you will need to follow the same following steps to change the trigger hand of your gunstock. The images represent a MagTube with static MK1 Stock, but this is the same for a MagTube with MK2 stock or ForceTube with haptic stock.

🕒 Switching the laterality of your MagTube / ForceTube gunstock should take 20 min.

Make sure you work in a clear area and be very careful, some parts can be lost easily.

For steps 1 & 2, if you want to switch from left-handed to right-handed, you just need to flip the way the magnetic supports are mounted.

STEP 1: REAR SIDE / Right to left-handed

You will need the provided tools (Allen key) to complete this step.

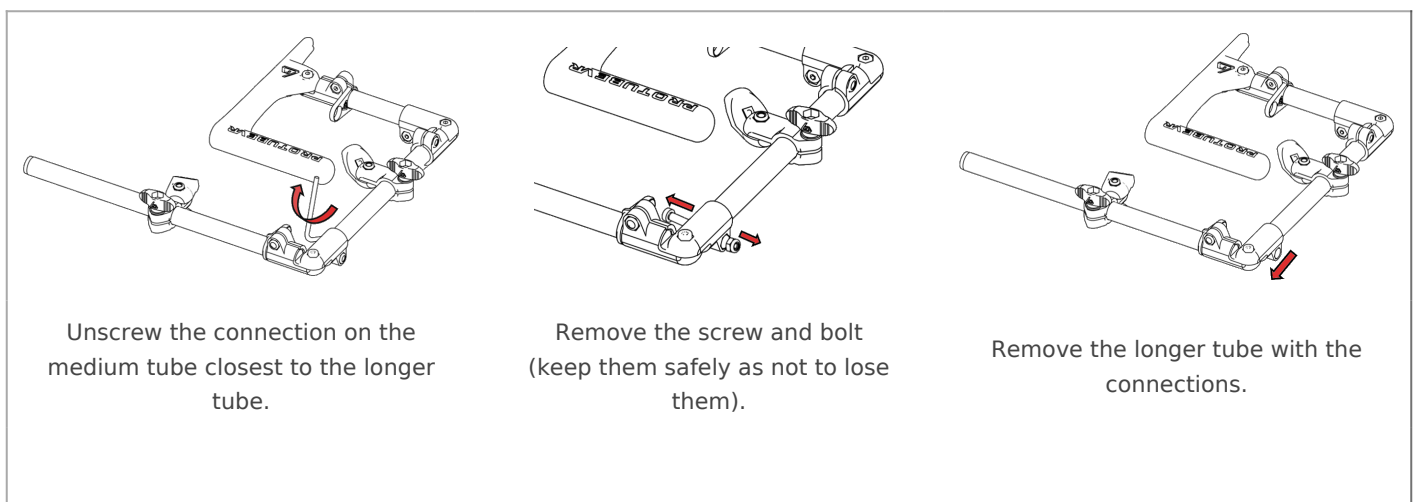

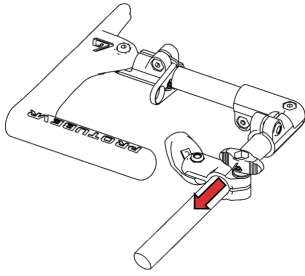

By loosening the butterfly screw, slide the magnetic bracket attachment out.

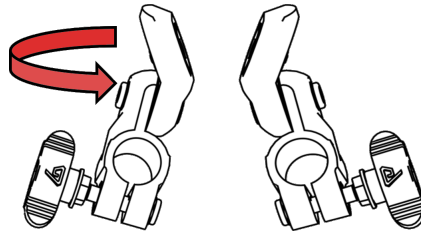

Flip the magnetic bracket attachment.

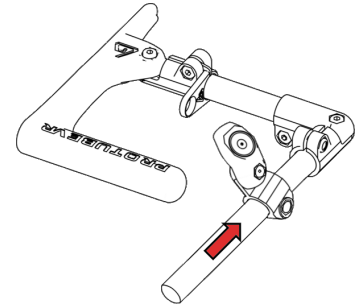

Put it back on the other way like shown.
And tighten the butterfly screw to hold it in place (not too much, you may need to adjust it later).

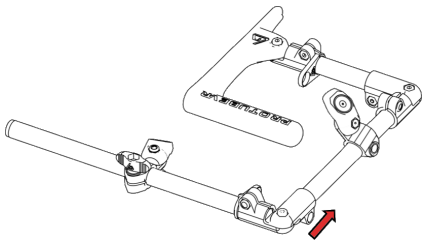

Put the connection back on the tube.

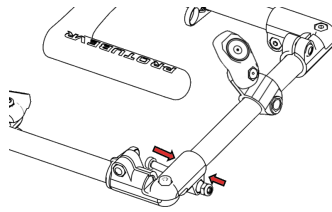

The screw and bolt as well.

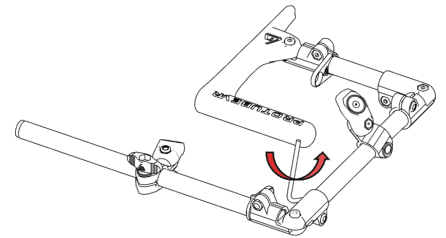

Tighten the screw but not too much, you will need to adjust the gunstock once you're done.

STEP 2: FRONT SIDE / Right to left-handed

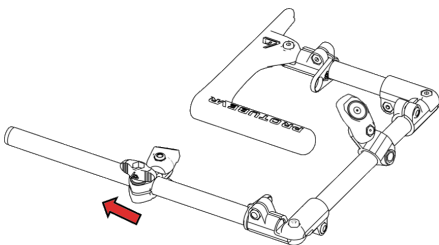

By loosening the lower butterfly screw, slide the magnetic bracket attachment out.

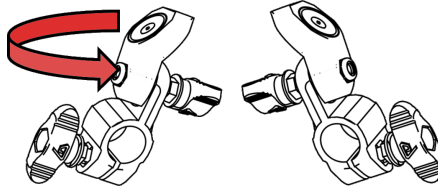

Flip the magnetic bracket attachment.

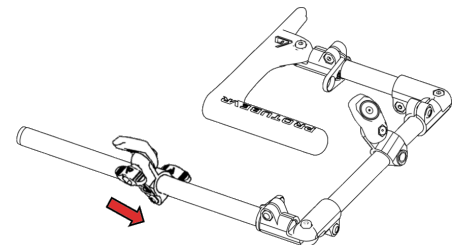

Put it back on the other way like shown.
And tighten the butterfly screw to hold it in place (not too much, you may need to adjust it later).

STEP 3: ADJUSTMENTS

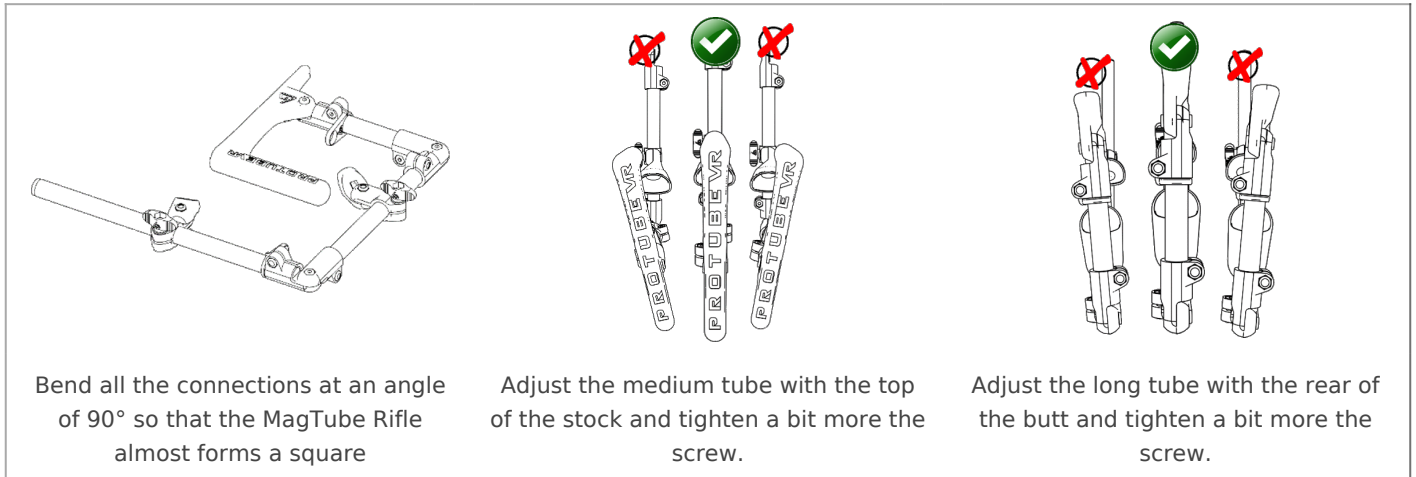

Bend all the connections at an angle of 90° so that the MagTube Rifle almost forms a square

Adjust the medium tube with the top of the stock and tighten a bit more the screw.

Adjust the long tube with the rear of the butt and tighten a bit more the screw.

STEP 4: FINAL TOUCH

You can magnetically attach the cups to the black magnetic supports.
Make sure the logo on the cups are facing the front of the Rifle.

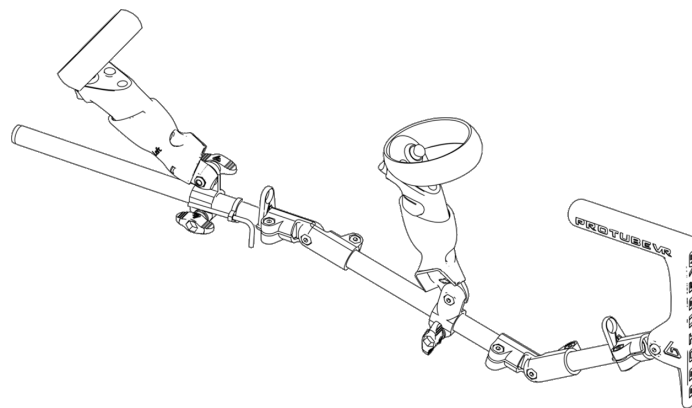

Congratulations!

Your MagTube rifle is now on the other side!

As a reminder, if you just got it, your MagTube/ForceTube will highly improve your freedom, reaction time, aiming and efficiency after some training. It may take some time to get used to.

Thank you for choosing the best Virtual Reality stock rifle solution. But don't take our word for it, try it. And most importantly, enjoy your games!

Gunstock MagTube ForceTube Setup EN

You laid your hands on one of our MagTube rifle, with MK1 classic stock or MK2 adjustable stock, or the ForceTube rifle, with haptic recoil stock.





For both, you will use the same following steps to build your gunstock. The images represent an MK1 classic stock, but this is the same for an MK2 adjustable stock or ForceTube haptic stock.









🕒 Mounting your MagTube / ForceTube gunstock should take 45m.

For video setup, [you can check our YouTube Playlists](#).

Make sure you work in a clear area and be very careful, some parts can easily be lost.



PARTS LIST

Bag N°1					
					
x1	x2	x1	x2	x1	x1
Sling ring	Connection with internal notches	20mm screw	O'ring	Nut	Notched Washer









Bag N°2							
							
x2	x1	x1	x1	1x	1x	x4	x2

Connection with external notches	T-notched connection	Hex screw	Butterfly	Hex washer	20mm screw	O'ring	Nut
----------------------------------	----------------------	-----------	-----------	------------	------------	--------	-----

Bag N°3								
								
x1	x1	x1	x2	x2	x2	x2	x1	x2
Ring Wedge	Connection with internal notches	T-notched connection	Hex screw	Butterfly	O'ring	Nut	Rubber washer	Hex washer

Tool bag	
	
x1	x1
0,4cm Hex Key	0,25cm Hex Key

MagTube - Rest of the Box

								
x1	x1	x1	x1	x1	x2	x1	x1	x1
Set of 3 tubes (13, 20 & 25 cm) (Chrome or Carbon)			Sling (1 or 2 points)	Pair of controller mounts	Magnetic retainer	Static stock (MK1 or MK2)	Bipod (Optional)	Pair of ProStraps (Optional)

ForceTube - Rest of the Box



STEP 1: GUNSTOCK

You will need: bag n°1, the smaller tube and rifle stock.

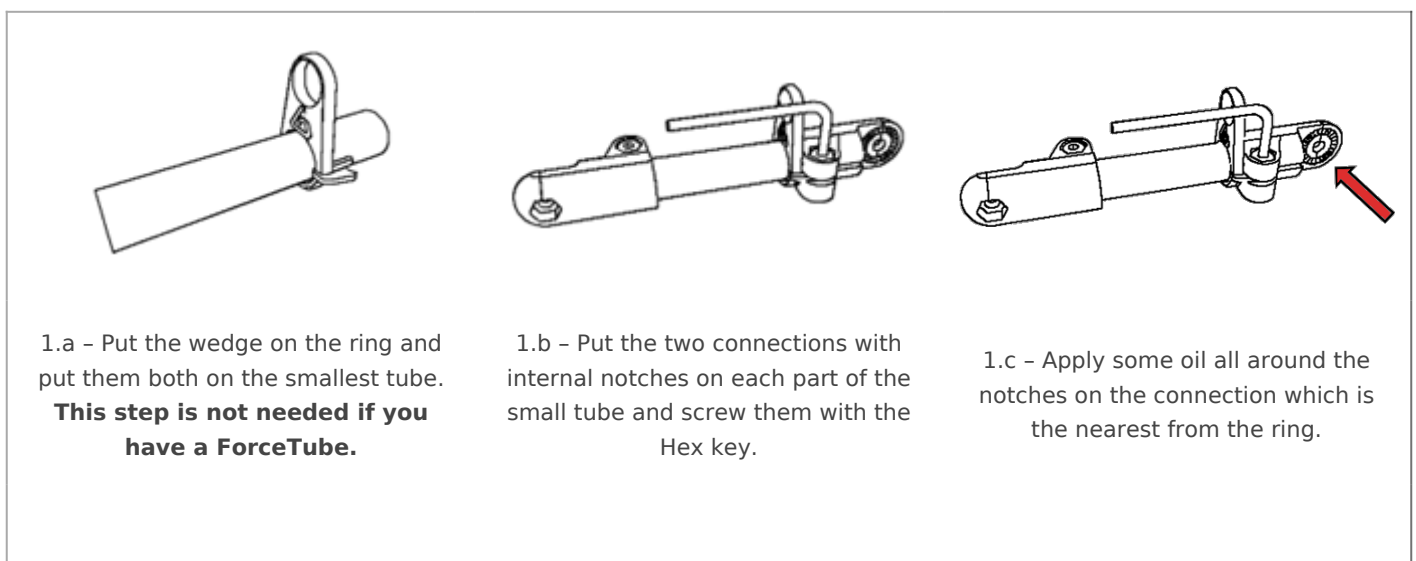



1.d - Put one O'ring on the 20mm screw, slot them both into the hole provided in the stock.

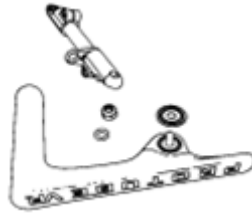

1.e - Then slide the notched washer (the notches have to be facing the same way) and the previously oiled connection over the screw.

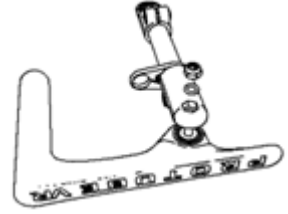

1.f - Attach the screw securing the stock and the connection with one O'ring and the nut.

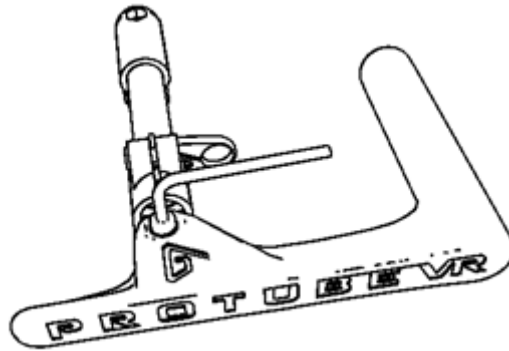

1.g - Screw all the pieces together, taking care not to over tighten. You must be still able to rotate the stock by force.

In the next steps, you will need the magnetic supports.
They are usually magnetically attached to the cups.
The magnets are quite strong when trying to detach them with hands, but do not be afraid of breaking them, they are made to resist this step.
You just need a little force to separate them.

https://www.protubevr.com/img/cms/Content_Support/Retrait
To help, here is a [.gif that shows how to separate them.](#)

STEP 2: REAR SIDE

You will need: bag n°2, medium tube and notched magnetic bracket.

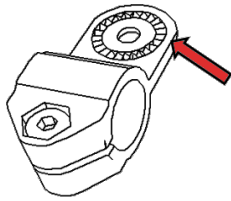

2.a - Apply some oil all around the notches on the T-notched connection. *The mag support is usually attached to the MagCup.*



2.b - Put one O'ring on the 20mm screw, slot them both into the hole provided in the notched magnetic bracket.



2.c - Then slide the previously oiled T-notched connection over the screw



2.d - Put one O'ring on the 20mm screw, slot them both into the hole provided in the stock.

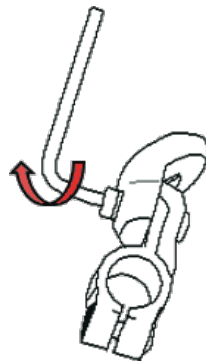

2.e - Screw all the pieces together, taking care not to over tighten. You must be still able to rotate the two parts by force.

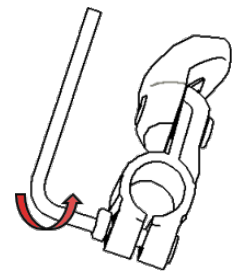

2.f - Unscrew the 18mm screw at the base of the T-notched connection. You will need it at the step 2.I).

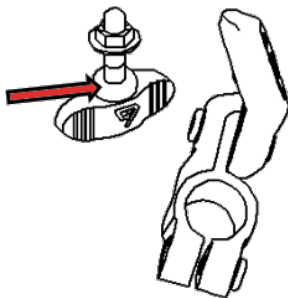

2.g - Set the butterfly screw on the hex washer. (note to Tao: the arrow is a separate image)

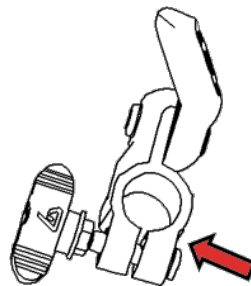

2.h - Screw the butterfly with the Hex screw to a nut on the other side

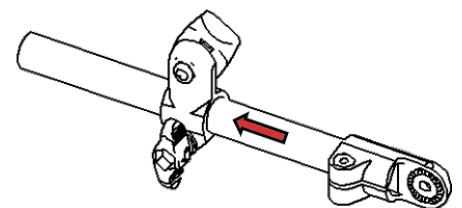

2.i - Slide the medium tube into the T-notched connection.

- If you aim with the right eye, the magnet must be facing right side.
- If you aim with the left eye, the magnet must be facing left side.

Then place the external notched connections on both side of the tube.

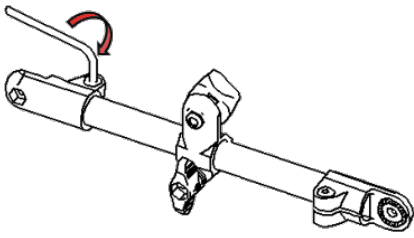

2.j - Finally screw the two external notched connections on the tube.

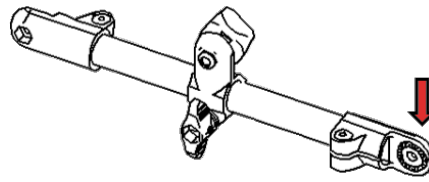

2.k - Apply some oil all around the external notches of the rear side.

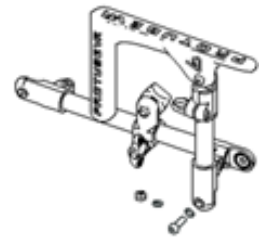

2.l - Place one O'ring on the 18mm screw (the one from 2.f). Slide them both through the internal notched connection and the external connection.

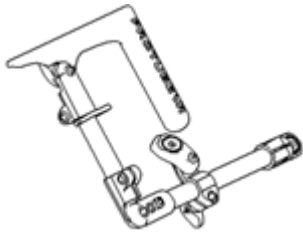

2.m - Attach the screw securing both connection with one O'ring and the nut.

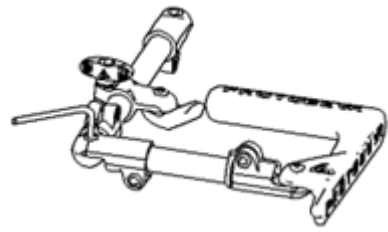

2.n - Screw all the pieces together taking care not to over tighten. You must be still able to rotate the two parts using force.

STEP 3: FRONT SIDE

You will need: bag n°3M, longer tube and smooth magnetic bracket.

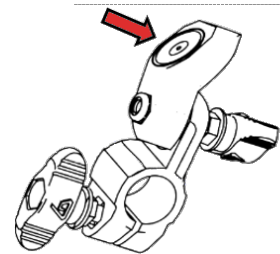
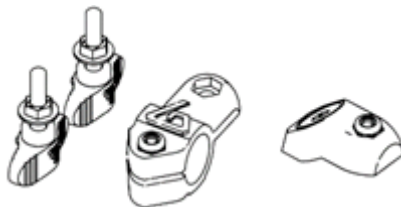
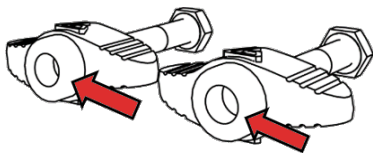

The mag retainer is usually attached to the MagCup (cf. intro of instruction)

3.a - Apply a dot of oil on the base of the butterflies part and attach each butterfly with one Hex screw.

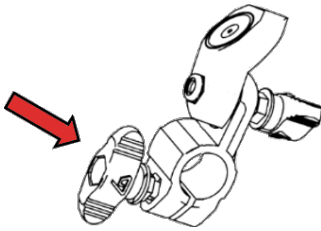

3.b - Remove the 18mm screw on the T-notched connection. You will need it at step 3.j.

Put the hex washers on the butterfly screws.

Put one nut on the T-notched connection and one on the smooth magnetic bracket.

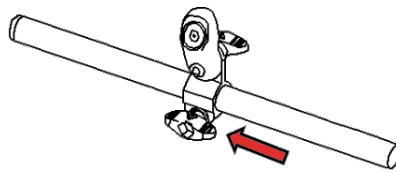

3.c - Slot one butterfly screw into the hole provided on top of the T-notched connection.

Then slot into the rubber washer.

Then slot into the smooth magnetic bracket. Finally, secure with a nut.

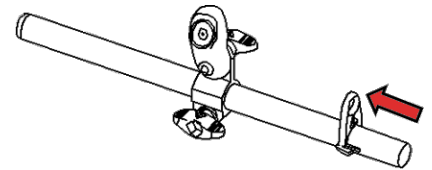

3.d - Slide the other butterfly screw through the T-notched connection on the none-logo side.

Secure with the nut previously installed in 3.b.

3.e - Put the previously assembled part through the longest tube.

- If you aim with the right eye, the magnet must be facing left side.
- If you aim with the left eye, the magnet must be facing right side.

3.f - Put the wedge on the ring and slide them through the stock of the tube.

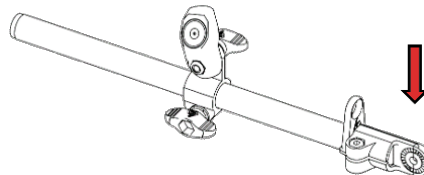
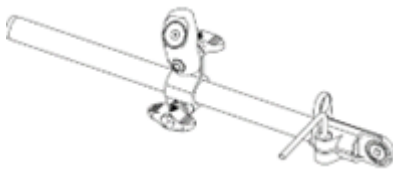

3.g - Put the connection with internal notches on the tube and screw it with the Hex key.

3.h - Apply some oil around the internal notches.

3.i - Place one O'ring and the nut on the internal notched connector.

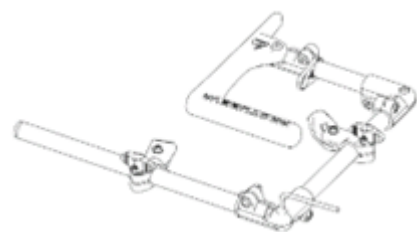
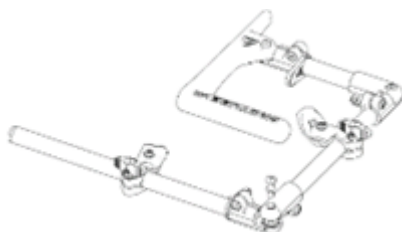

3.j - Place one O'ring on the 18mm screw previously removed from the T-notched connector (step 3.b).

Slide them both through the external notched connection and the internal connection.

Secure it with the nut on the other side.

3.k - Screw all the pieces together taking care to not over tighten. You must be still able to rotate the two parts by force.

STEP 4: ADJUSTMENTS

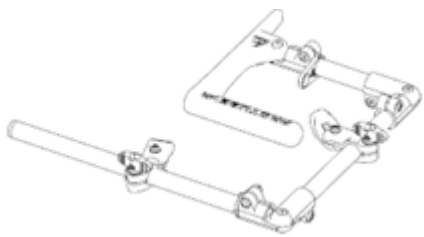

4.a - Bend all the connections at an angle of 90° so that the MagTube Rifle almost forms a square.



4.b - Adjust the medium tube with the top of the stock and tighten a bit more the screw from step 1.b.

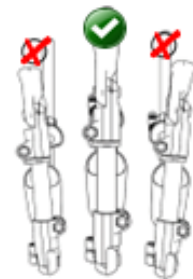

4.c - Adjust the long tube with the rear of the butt and tighten a bit more the screw from step 2.j.

STEP 5: FINAL TOUCH

You can magnetically attach the cups to the black magnetic holders.

Make sure the logo on the cups are facing the front of the Rifle.

Now, you can remove the wrist straps of your controllers and replace them with the ProTubeVR ones.

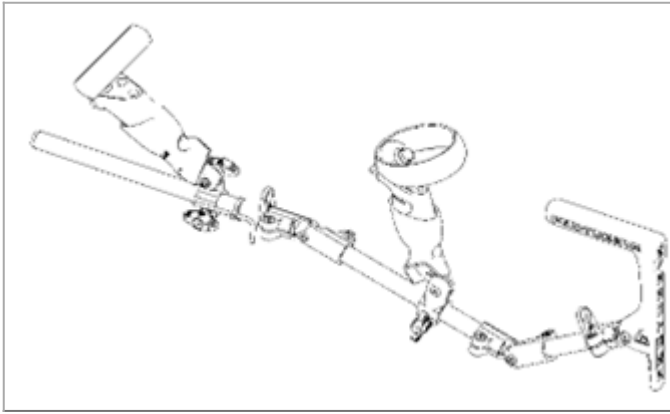

Congratulations!

Your MagTube rifle is now operational!

As a reminder, your MagTube will highly improve your freedom, your reaction time, and your efficiency after some training. It may take some time to get used to.